

# \$30,000 - Sasha Drive, Chillicothe

MLS® #220043208

## \$30,000

Bedroom, Bathroom,  
Land/Farm on 0.23 Acres

Crosscreek Phase 1 - Lot #34, Chillicothe, OH

Single Family Lot/Vacant/Sewer and Water  
available/Water tap fees already paid by Seller

Listing Courtesy Andrew W Whapham (614)  
989-8412 of Community Investment Real  
Estate (614) 989-8412

## Essential Information

MLS® #	220043208
Price	\$30,000
Acres	0.23
Type	Land/Farm
Sub-Type	Residential Land
Status	Active

## Community Information

Address	Sasha Drive
Area	Union
Subdivision	Crosscreek Phase 1 - Lot #34
City	Chillicothe
County	Ross
State	OH
Zip Code	45601

## School Information

District	UNION SCIOTO LSD 7106 ROS CO.
----------	-------------------------------

## Additional Information

Date Listed	December 15th, 2020
Days on Market	1

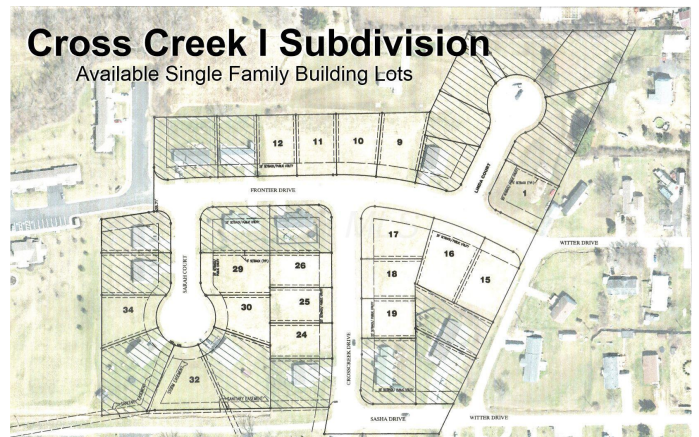

Zoning n/a

Copyright © 2021, Columbus Board of REALTORS® MLS. All information provided is deemed reliable but is not guaranteed and should be independently verified. The IDX information is provided exclusively for consumers' personal, non-commercial use, it may not be used for any purpose other than to identify prospective properties consumers may be interested in purchasing. All information provided is deemed reliable but is not guaranteed accurate by the MLS and should be independently verified.